

Turning & Facing & Chamfering

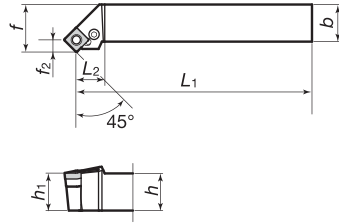
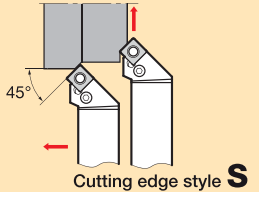

Right hand (R) shown.

4

TAC External Toolholders

Toolholders Cat. No.	Stock		Dimensions (mm)							Std. Corner r_E	Applicable inserts	Page
	R	L	h	b	L_1	L_2	h_1	f	f_2			
PSSNR/L1616H09E	●		16	16	94	16	16	20	6.1	0.8	SN□□0903□□	2-61 ~
PSSNR/L2020K12E	●	●	20	20	116	21	20	25	8.3	0.8	SN□□1204□□	2-61 ~
PSSNR/L2525M12E	●	●	25	25	141	21	25	32				
PSSNR/L3225P12E	●	●	32	25	161	21	32	32				
PSSNR/L2525M15E	●	●	25	25	140	25	25	32	10.2	1.2	SN□□1506□□	2-64 ~
PSSNR/L3225P15E			32	25	160	25	32	32				
PSSNR/L3232P15E			32	32	160	25	32	40				
PSSNR/L3232P19E	●		32	32	157.5	27.5	32	40	12.5	1.2	SN□□1906□□	2-64 ~
PSSNR/L4040R19E			40	40	187.5	27.5	40	50				

● : Stocked items.