

Turning & Facing & Chamfering

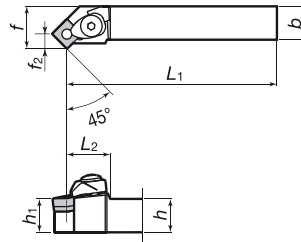
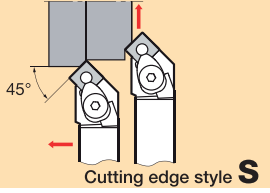

Right hand (R) shown.

Toolholders Cat. No.	Stock		Dimensions (mm)						Std. Corner $r_\epsilon$	Applicable inserts	Page	
	R	L	$h$	$b$	$L_1$	$L_2$	$h_1$	$f$				$f_2$
<b>DSSNR/L2020K12</b>	●	●	20	20	125	34.3	20	25	8.3	0.8	SN□□1204□□ (Except for 57-type chipbreaker inserts)	2-61 ~
<b>DSSNR/L2525M12</b>	●	●	25	25	150	34.3	25	32				